

**classe 8**  
•DE

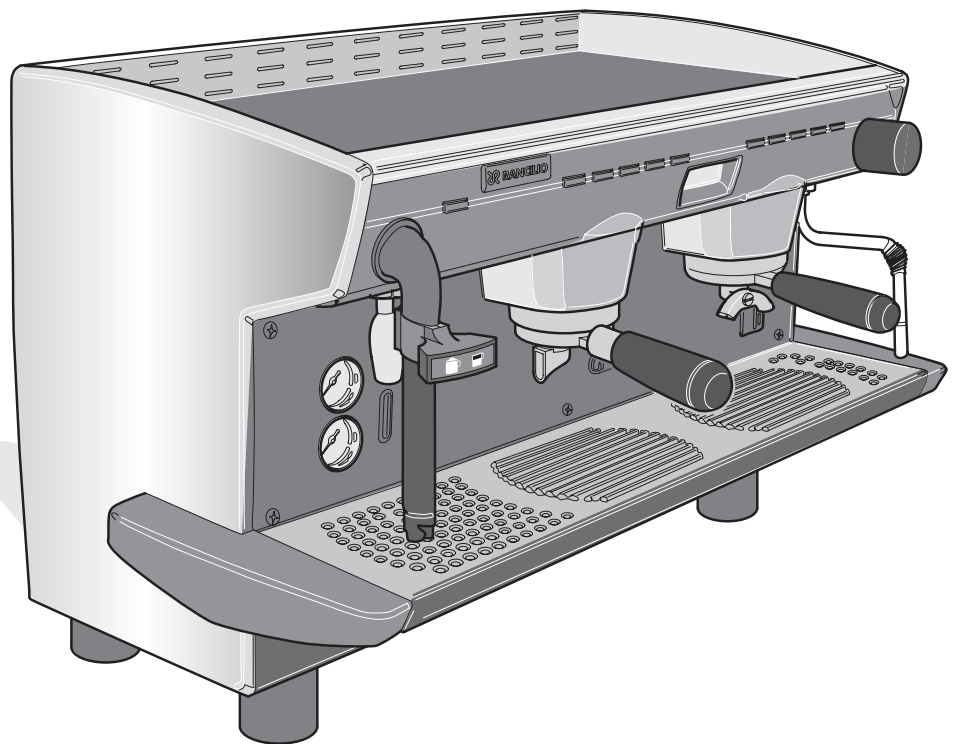

---

## **CONTENTS**

|           |  |           |
|-----------|--|-----------|
| <b>1.</b> | <b>Programming .....</b>                       | <b>3</b>  |
|           | 1.1 Washing of the coffee groups               |           |
|           | 1.2 TSC Washing (mod.DE)                       |           |
|           | 1.3 TSC quick washing                          |           |
|           | 1.4 Reset                                      |           |
|           | 1.5 Timer cut-out                              |           |
| <b>2.</b> | <b>Technician programming .....</b>            | <b>4</b>  |
|           | 2.1 Select display language                    |           |
|           | 2.2 Visualize and reset the total calculations |           |
|           | 2.3 Dose programming                           |           |
|           | 2.4 Check distribution time                    |           |
|           | 2.5 International settings                     |           |
|           | 2.6 Cleaning                                   |           |
|           | 2.7 Visualize date and pressure                |           |
|           | 2.8 Adjust boiler pressure                     |           |
|           | 2.9 TSC functions                              |           |
|           | 2.10 Align probes                              |           |
|           | 2.11 Software version and date                 |           |
| <b>3.</b> | <b>Visualizations .....</b>                    | <b>9</b>  |
|           | 3.1 Heating phase                              |           |
|           | 3.2 Machine ready                              |           |
|           | 3.3 Safety devices                             |           |
|           | 3.4 Dose programming phase                     |           |
|           | <b>Wiring Diagrams .....</b>                   | <b>10</b> |
|           | <b>Hydraulic Diagrams .....</b>                | <b>12</b> |
|           | <b>Board Diagram .....</b>                     | <b>14</b> |
|           | <b>Voltage Jumper Settings .....</b>           | <b>16</b> |



# 1 PROGRAMMING

Use the first coffee keyboard with keys having the following functions :

1° Button Enter programming  
Keeping pressed for 8 sec. you enter programming, then you have:

- 1° Button "+" To move to a higher level in the programming menus. Or to increase the value
- 2° Button "-" To move to a lower level in the programming menus. Or to decrease the value
- 3° Button "enter" To enter the programming menu. Or to confirm entries
- 4° Button "esc" To quit the menu Or to quit programming mode.
- 5° Button Key off.

## 1.1 Washing of the coffee groups

At the fixed time, if the automatic washing mode is enabled, a message on the display requests to wash the coffee groups.

Keep "ENTER" button pressed to start washing until the display shows:

**"Cleaning needed"**

**"Press enter"**

If you press "enter" within 5 seconds, the following cycle starts (if you do not leave this menu automatically):

- The display shows:

**"Insert the blind filters then press enter"**

- When you press "enter", the cleaning cycle starts and the display shows:

**"Cleaning runnign"**

The machine carries out n. 10 cycles as follows:

- Starts dispensing from the groups for 10 sec.
- Pauses for 10 sec.

At the end of the 10 cycles, the display reads:

**"Remove the filterholders, press enter"**

If you press "enter" the display shows:

**"Rinsing"**

The machine carries out n. 2 cycles as follows:

- Starts dispensing from the groups for 30 sec.
- Pauses for 30 sec.

If "esc" button is pressed during the cycle, the current washing phase will stop and the next phase will take place.

**N.B.** In the washing and rinsing phases the groups are operated alternatively.

In any case the washing of the coffee groups can be enabled whenever necessary according to the previously described procedure.

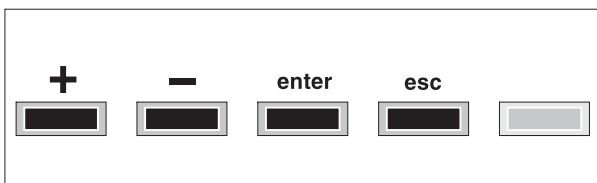
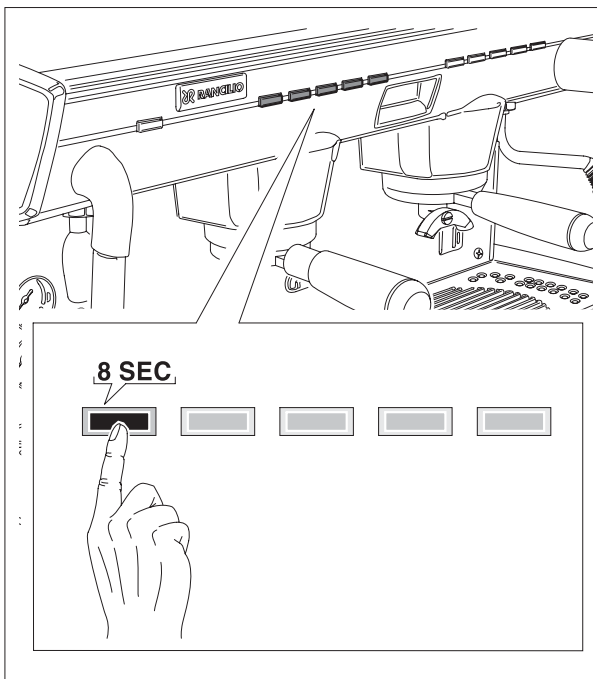

## 1.2 TSC Washing (mod.DE)

At the set time, if the automatic washing mode is enabled, a message on the display will request the TSC washing.

Prepare a container with water and detergent to remove any milk. Insert the silicone pipe on the hose holder, remove the nozzle and immerse it into the container with detergent.

Keep "-" button (2nd button) pressed to start washing until the display shows:

**"Perform TSC washing?"**

**"Press enter"**

If "enter" is pressed within 5 sec. the following cycle will be started (otherwise you will automatically exit from this menu):

- the display will show:

**"Prepare detergent"**

**"then press enter"**

- by pressing "enter" the cycle will be started and the display will show:

**"Washing under way"**

no.2 dispensing cycles are carried out as follows:

- steam dispensing start for 30 sec.
- pause for 2 sec.

At the end of the 2 cycles the display will show:

**"Prepare rinsing water"**

**"then press enter"**

By pressing "enter" the display will show:

**"Rinsing under way"**

and no.2 cycles will start as follows:

- steam dispensing start for 1 min.
- pause for 2 sec.

If "esc" button is pressed during the washing cycle the current phase is stopped and the next phase will take place.

Rinsing phases cannot be avoided.

In any case the TSC washing can be enabled whenever necessary according to the previously described procedure.

### 1.3 TSC quick washing

If enabled, at the programmed interval the display will show the message to carry out TSC quick washing and both leds of TSC keys will flash.

Press one of the two keys to carry out quick washing (steam dispensing for approx. 3 sec.)

### 1.4 Reset

Keeping pressed key "ESC" (key 4 of push button panel 1) and the machine is switched on, all data set in the program are reset and default standard data are automatically entered (coffee doses, water doses, boiler pressure, etc.)

### 1.5 Timer cut-out

If the machine is turned off by the program, by pressing key 4 of keyboard 1 at least for 3-4 seconds it will turn on again and remain on until the following programmed stop or by pressing the same key again. If the machine is turned on by the program, by pressing key 4 of keyboard 1 at least for 3-4 seconds it will turn off again and remain off until the following programmed stop or by pressing the same key again.

## 2. Technician programming

To access programming functions reserved to technicians, proceed as follows:

- Turn off the machine
- Press key 5 and turn on the machine at the same time
- Keep key 5 pressed until the display shows the first item of the programming menu

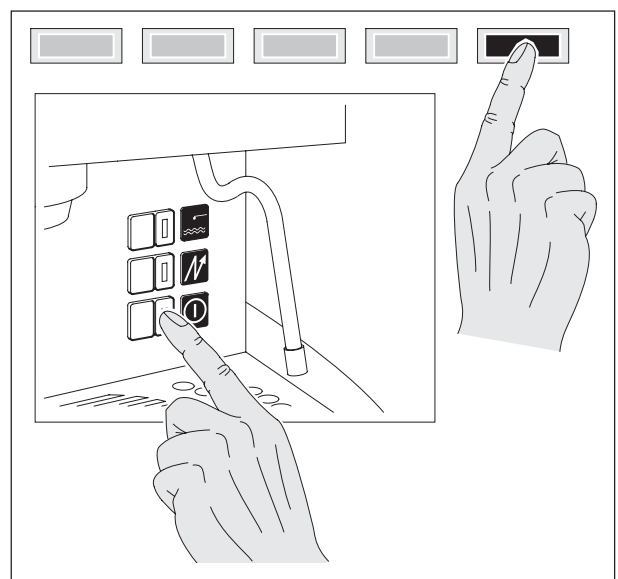
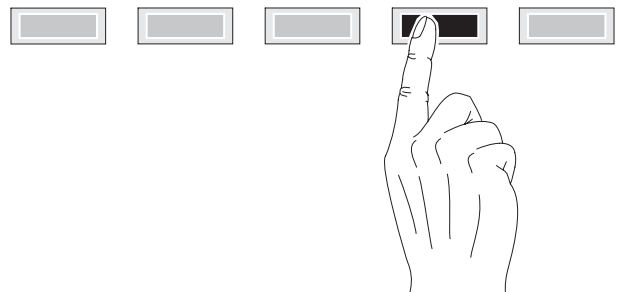
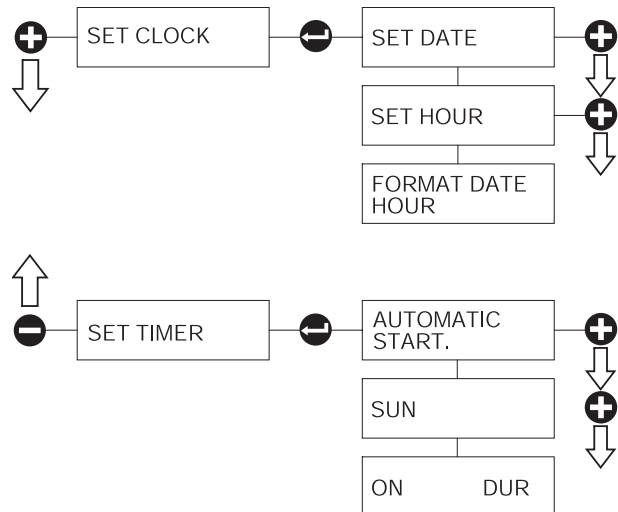

- Select display language
- Visualize and reset total calculations
- Dose programming
- Check distribution time
- International settings
- Enable washing
- Visualize date/pressure
- Adjust pressure
- TSC function
- Align probes
- Software version and date

To browse from one menu to another press "+" or "-", to enter a sub-menu or to confirm a variation press "enter", to exit press "esc".

The value that can be modified with "+" or "-" keys is flashing.

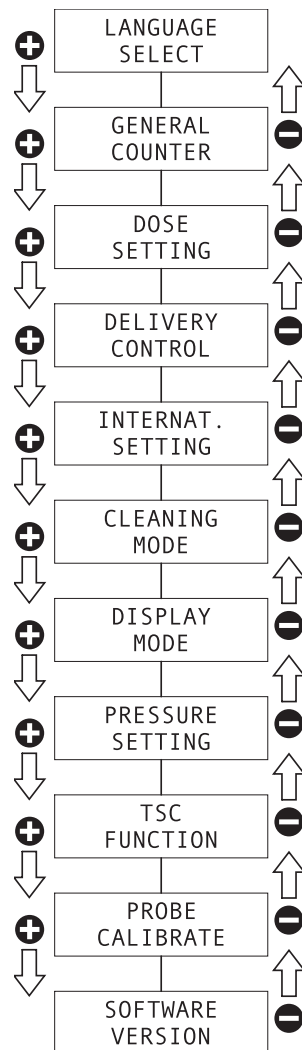

## 2.1 Select display language

Menu to select the language to be used for display visualizations.

Messages in the following languages shall be provided:

- Italian-French-German-Spanish-Portuguese

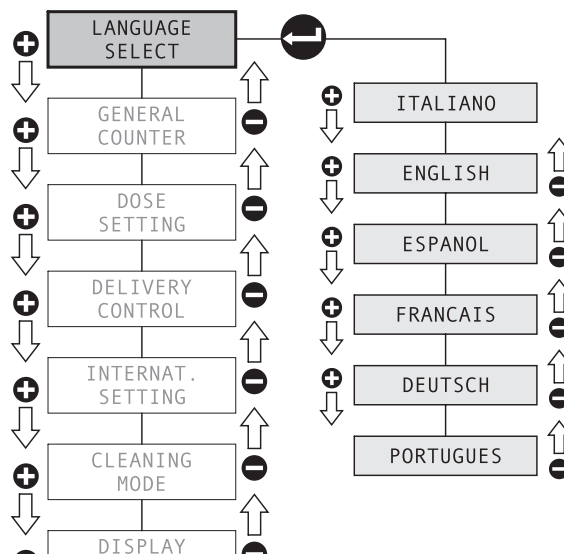

## 2.2 Visualize and reset the total calculations

The calculations for each selection made are visualized and requested whether to set the counters to zero or not.

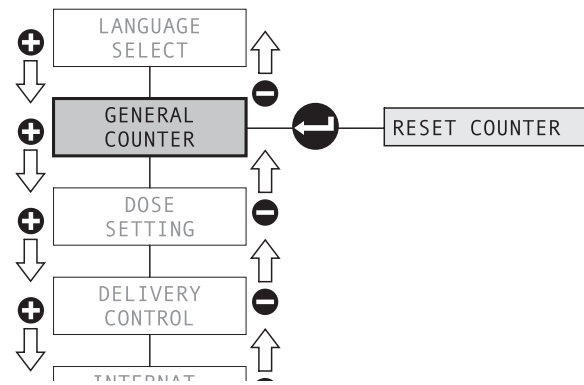

## 2.3 Dose programming

It visualizes the pulses and the pre-infusion time for each coffee and hot water distribution time for each button.

Doses are varied with "+" and "-" buttons.

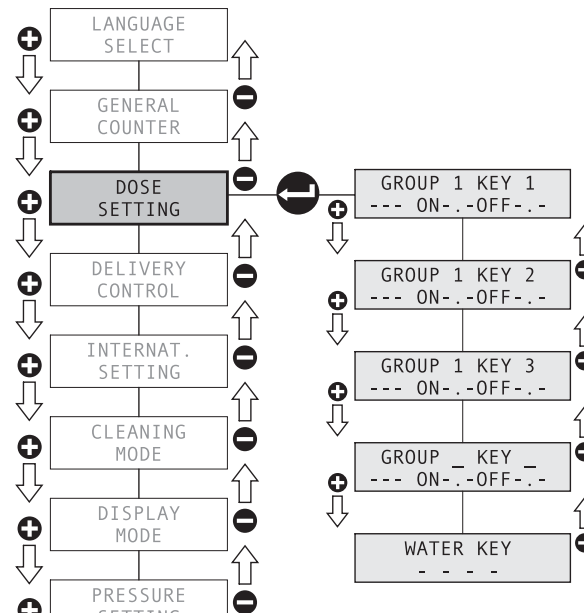

## 2.4 Check distribution time

Possibility of activating one of the following functions:

- Function "0" – Function not enabled
- Function "1" – During the dose programming phase, in self-learning or at the first distribution after varying a dose, the time of each distribution is stored. This time is compared during the following distributions and will be displayed for a t12 time at the end of the distribution:
- "O.K." if the distribution time falls within a tolerance of +/- 3 sec
- on the contrary if the difference in seconds is higher than the tolerance, the non-corrected data will be displayed (ex. "+5")
- Function "2" – the distribution time for each coffee will be displayed at the end of the distribution of a t12 time.

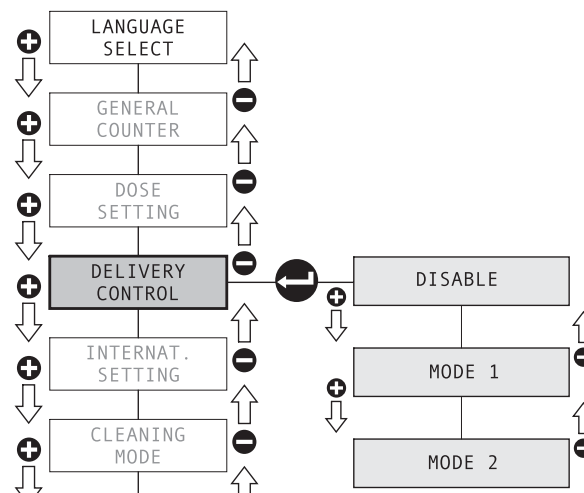

## 2.5 International settings

Selection of the measures to be used for pressure and temperature from ba to P.S.I. and from C to °F°.

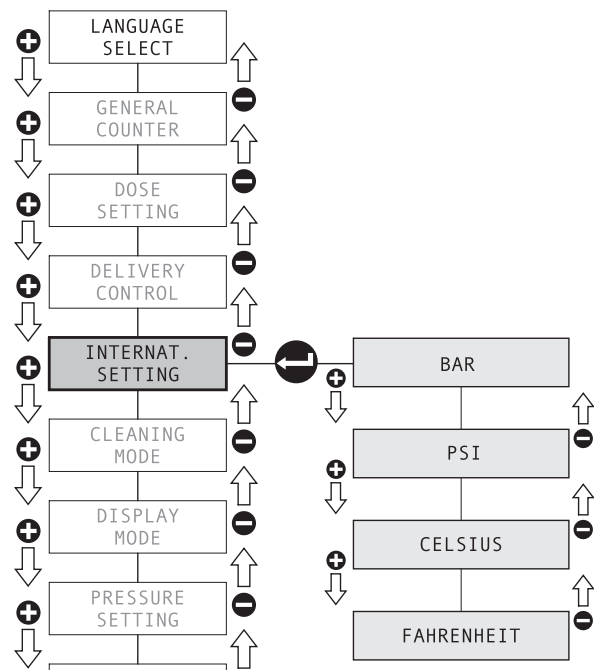

## 2.6 Cleaning

This submenu gives the possibility of setting all modes concerning the washing of coffee groups, TSC and washing counters.

If the automatic operation mode is set for one or both cases (coffee groups and TSC), at the fixed time, a message on the display will remind to start the washing cycles.

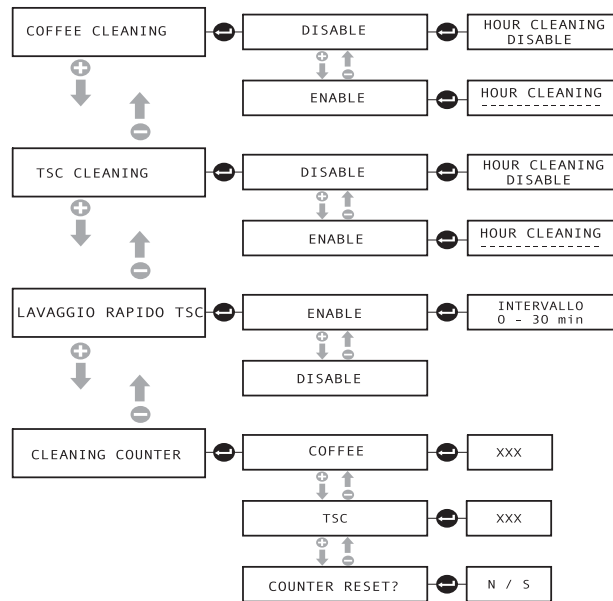

## 2.7 Visualize date and pressure

Setting of the display visualization of date/time or boiler pressure value.

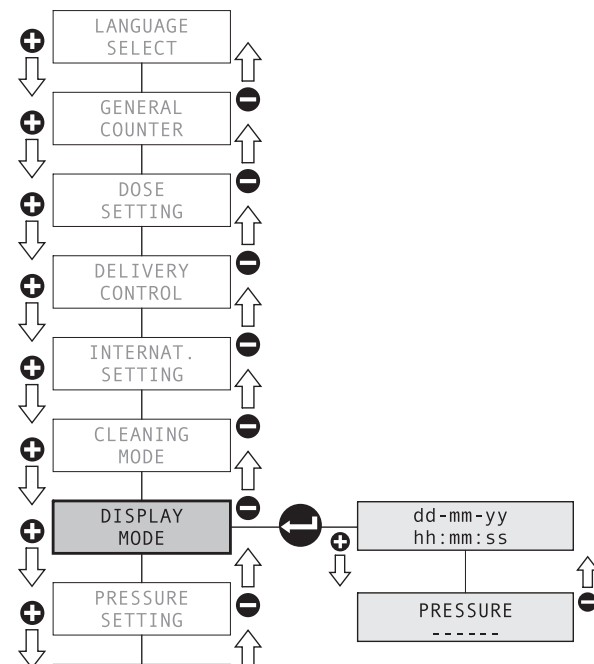

## 2.8 Adjust boiler pressure

Adjustment of the boiler pressure values with value increase of 0,05 bar.

## 2.9 TSC functions

The temperature values and milk cream level are set. The following options are visualized:

For "whipped milk" the final milk temperature can be set (in °C / °F degrees) as well as the whipping level ranging from 1 to 12.

Also for "non whipped milk", in addition to the final temperature, a slight whipping can be set (ranging from 1 to 12).

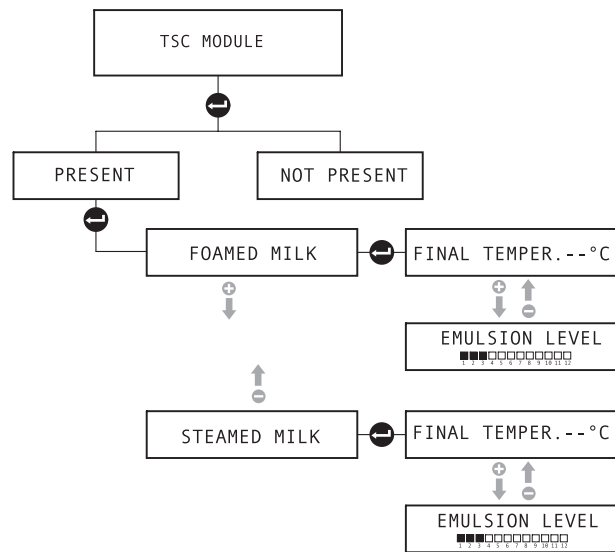

## 2.10 Align probes

### Boiler temperature probe alignment

This function allows to carry out via software the alignment of the boiler temperature probes in relation to a reference value.

The display shows the pressure measured by the probe in real time and the corresponding alignment value.

Make sure that the pressure read with a reference manometer corresponds to the value read by the probe. Should the manometer show a higher or lower pressure, correct with "+" or "-" buttons in order to carry out the temperature control system alignment; press "enter" to confirm.

### Align TSC temperature probe

This function allows to carry out via software the alignment of the TS system temperature probes in relation to a reference value.

The display shows the temperature measured by the probe and the corresponding alignment value.

Make sure that the pressure read with a reference manometer corresponds to the value read by the probe. Should the manometer show a higher or lower pressure, correct with "+" or "-" buttons in order to carry out the temperature control system alignment; press "enter" to confirm.

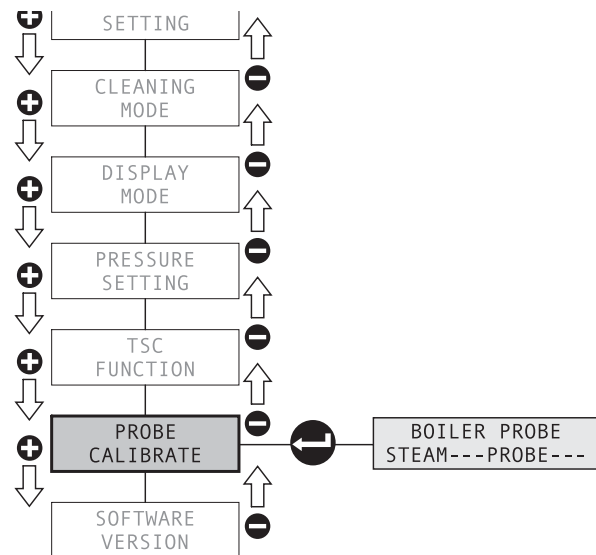

## 2.11 Software version and date

The software update version is shown on the display.

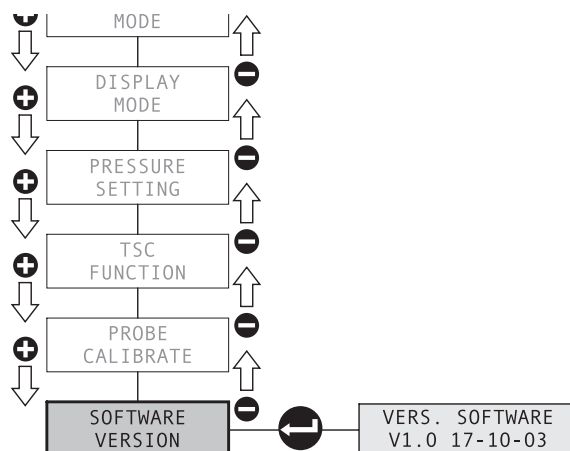

## 3 VISUALIZATIONS

### 3.1 Heating phase

When the coffee machine is heating up, the following words are shown:

MACHINE  
NOT READY

### 3.2 Machine ready

When the coffee machine is ready, the following words are shown:

dd-mm-yy  
hh:mm:ss

Or the boiler pressure:

P= 1,05 bar

During the distribution of a product (ex.milk) the following frame is shown:

Brew running  
xxx °C

If the "Distribution time control" function is activated, the following frame is shown:

GR1 GR2 MILK  
xxx xxx xxx °C

Groups 1 and 2 alternate with groups 3 and 4.

### 3.3 SAFETY DEVICES

3.3.1 In case of intervention of the safety device related to the water level in the boiler not reached in the fixed time, the following is shown:

Disable  
E01 Water miss.

In case of intervention of the safety device related to the heating time longer than the fixed time, the following is shown:

Disable  
E02 Pressure low

3.3.2 In case of intervention of the safety device related to a slow distribution, the led related to the distributed dose will flash until the distribution is finished.

### 3.4 Dose programming phase

During this phase, the "Dose programming" will be flashing.